

MEUBLES MACHINES A CAFE ET NEUTRES

Modèles SEFM

Gamme 600



SEFM60-100-S



SEFM60-150-S

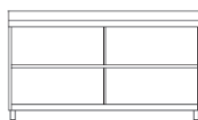

SEFM60-200-S



SEFM60-100-S

Caractéristiques Techniques

- Extérieur et étagères en inox AISI-304 (sauf partie arrière en galva)
- Dossieret de 100 mm en standard (sans dossieret sur demande)
- Pieds inox réglables de 135 à 210 mm

	Dimensions (LxPxH mm)	Poids (kg)	Nb de tiroirs	Nb de portes	Nb de trémie	Nb d'étagères
SEFM60-100-S	990x600x1040	49	0	0	0	1
SEFM60-150-S	1495x600x1040	60	0	0	0	1
SEFM60-200-S	2020x600x1040	71	0	0	0	1



SEFM60-150-S



SEFM60-200-S

FABRICATION ESPAGNOLE

SCHEMAS TECHNIQUES

SEFM60-100-S

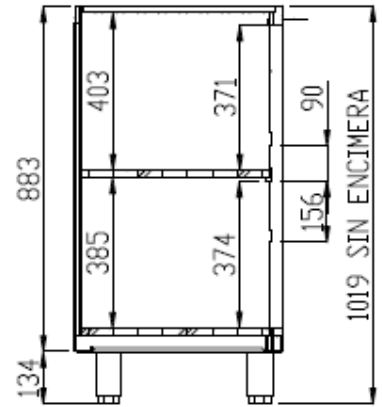
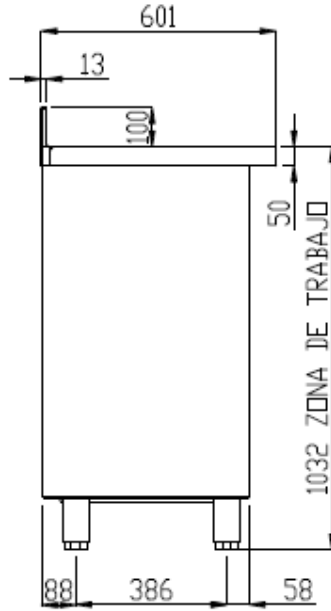
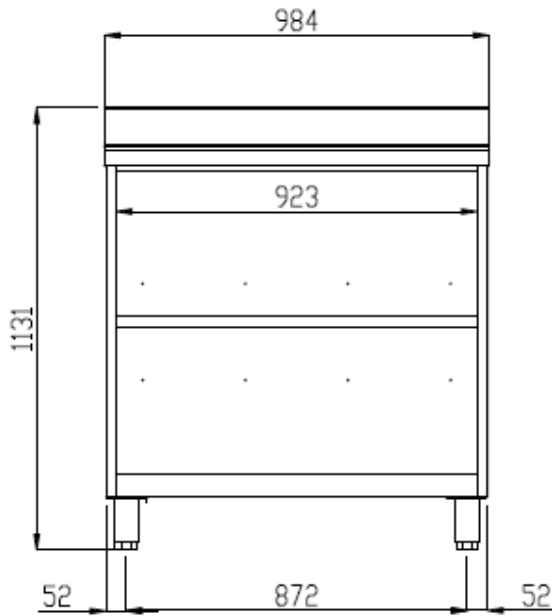

SIN ENCIMERA

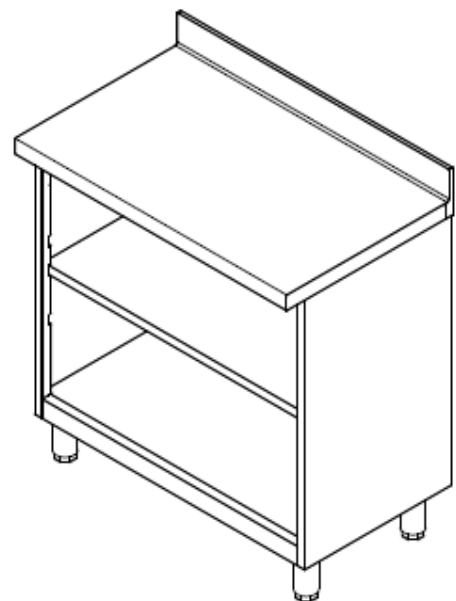
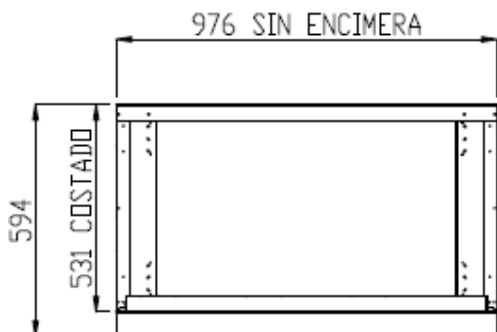
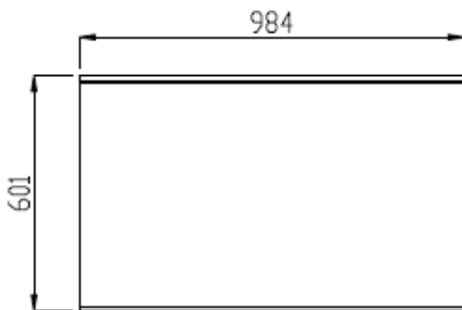

Cotas en mm

SEFM60-150-S

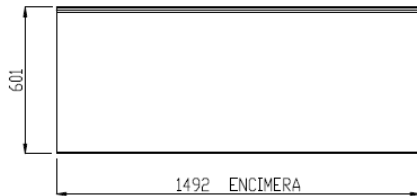
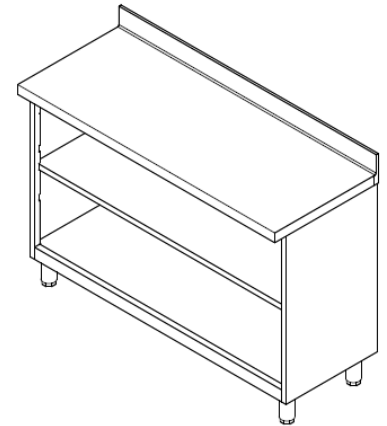
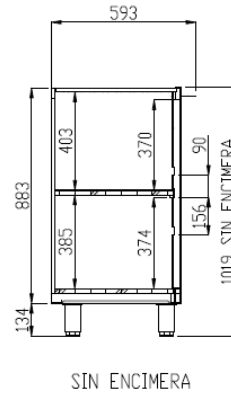
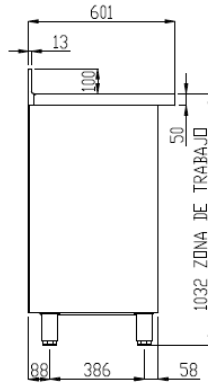
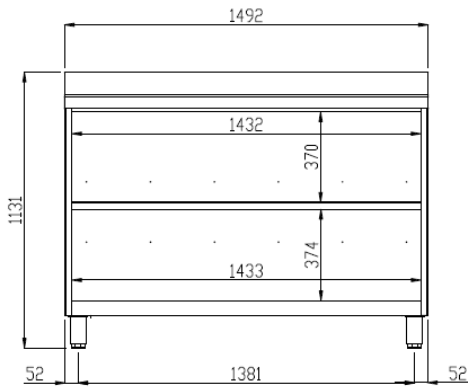

PATAS REGULABLES

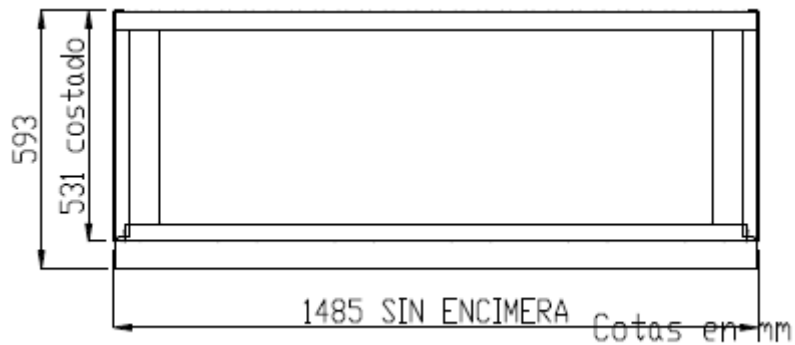

SEFM60-200-S

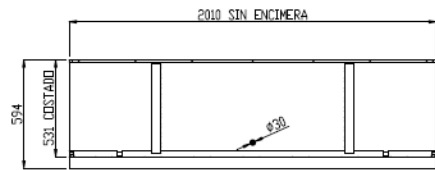
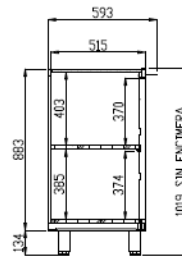
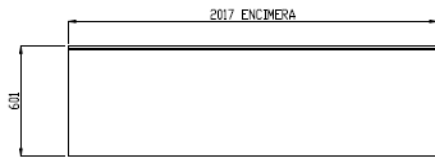
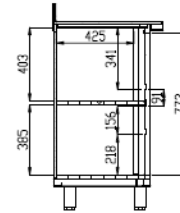
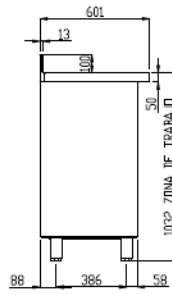
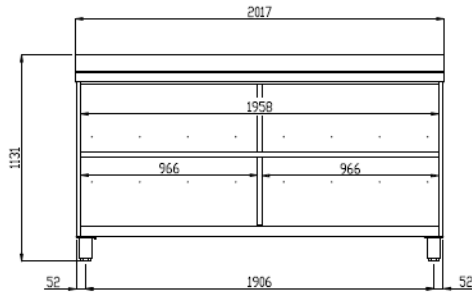

SIN ENCIMERA

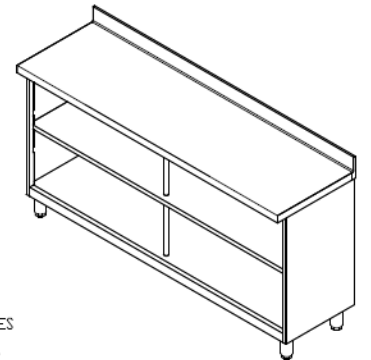

PATAS REGULABLES



Cotas en mm